

Data sheet

Support roller NATR 17 PP (crowned, with axial guidance, cage, seal)

Designation	NATR 17 PP
Type	crowned
D [mm]	40
d [mm]	17
d1 [mm max.]	32
B1 [mm]	19
B [mm]	20
r [mm]	1
Dynamic load Crw[N]	10900
Static load C0rw[N]	15500
Speed limit [min-1]	6000
Speed limit [min-1]	5500

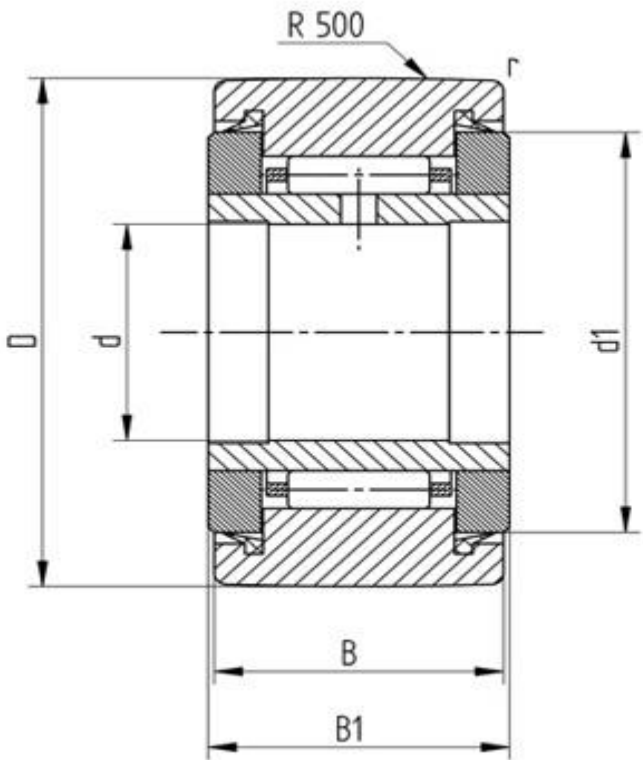

Every specification has been edited and verified carefully. STI Bearings GmbH assumes no liability for potential errors or incompleteness. Technical modifications are subject of changes.

© 2020 by STI Bearings GmbH
Reproduction, even excerpts, only with our approval.